

Installation Manual

Phanteks PH-TC12DX Thermal radiator for INTEL LGA 2011 / 1156 / 1155/ 1366 / 775, AMD FM1/AM3+/AM3/AM2+/AM2 (AMD Stock backplate is required)

Thank you very much for choosing a Phanteks cooler. This manual will guide you through the installation process of the SoliSku mounting system step by step.

Important! Before proceeding with installation, please check for the most up-to-date instructions at www.phanteks.com. Multilingual versions of this manual are also available on our website.

Supports & FAQ

For all enquiries concerning your Phanteks cooler, please contact the support team at support@phanteks.com. You can also consult the FAQ section on our website www.phanteks.com

Common required mounting parts:

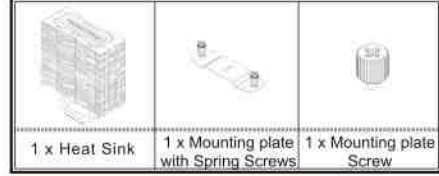

Required mounting parts for AMD FM1/AM3+/AM3/AM2+/AM2

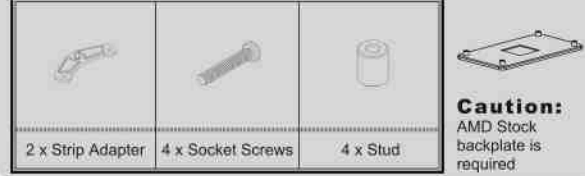

Caution: AMD Stock backplate is required

Required mounting parts for INTEL LGA 2011



Required mounting parts for INTEL LGA 1156/1155/1366/775

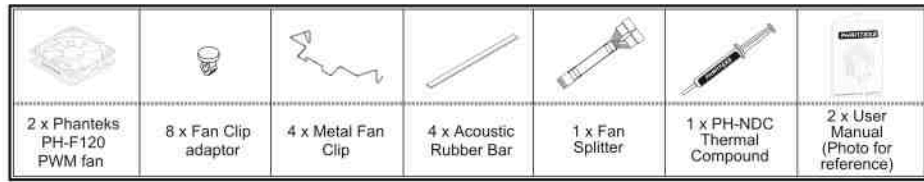
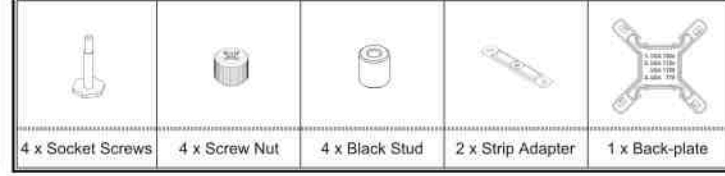

PH-TC12DX INTEL LGA 2011 Installation Guide

Step 1: Insert the 4 socket screws directly into mainboard.

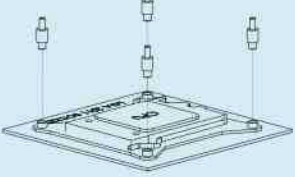

Step 2: Set the strip adaptor on the socket screws.

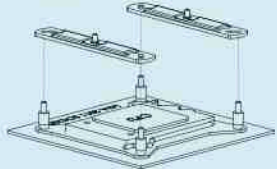

Caution: please refer to bracket position guide for this step.

Step 3: for this step please refer to step 5.

PH-TC12DX INTEL Installation Guide

Step 1: Removing the motherboard

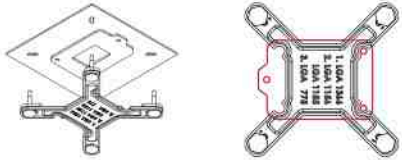

In order to use the Phanteks cooler in your system first you have to remove the motherboard from the case to install the backplate.

Caution: On LGA1366 and LGA1156/1155. Install the supplied backplate over the motherboard's stock backplate

Step 2: Setting up the backplate

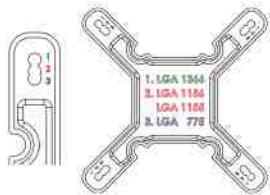

Apply each screw into the motherboard's INTEL CPU socket. (See Diagram below)

Caution: Please follow your socket position to put in the four socket screws as below.
Position 1: INTEL LGA 2011/1366
Position 2: INTEL LGA 1156/ LGA 1155
Position 3: INTEL LGA 775

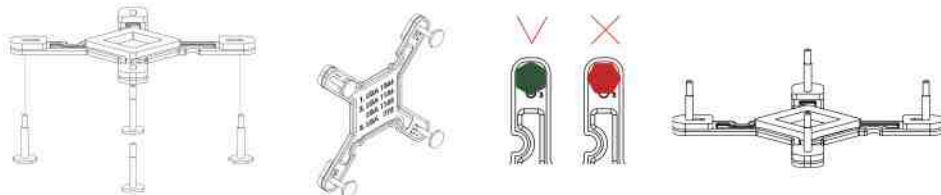

Caution: Please verify that all four socket screws are inserted correctly.

Step 3: Securing the black-plate

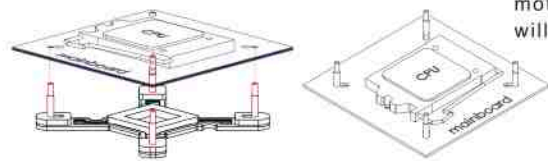

Place the backplate on the rear side of the motherboard properly, so that the socket screws will stick through the socket mounting holes.

Step 4: Install the stud and strip adapters

Place the four studs onto the socket screws.

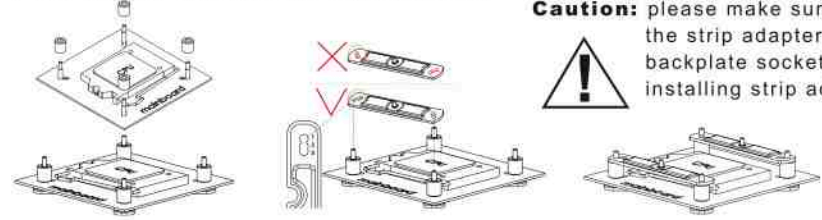

Caution: please make sure the socket hole of the strip adapters are correct following backplate socket hole to avoid wrong installing strip adapters.

WRONG !!

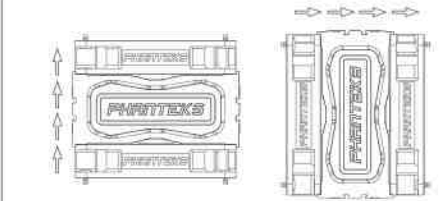
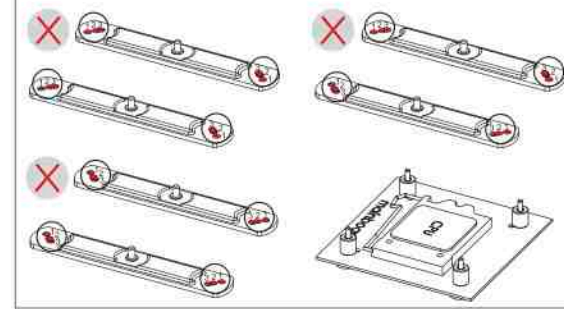

Caution: Choose the alignment of the INTEL mounting strip adapters according to your desired final orientation of the cooler:

Step 5: Fixing the two mounting strip adapters

Caution: Tighten the screws until stop.



Step 6: Applying thermal paste

If there are residual traces of thermal paste or thermal pads on your CPU, please clean them off first. Then press a small drop (4-5mm diameter) of Phanteks PH-NDC on the center of the CPU surface.

Step 7: Fixed SoliSku mounting plate on PH-TC12DX

Please put mounting plate onto cooler's alum. base cover and use mounting plate screw to fix the mounting plate.

Caution: Tighten the mounting plate screw until it stops.

Step 8: Place the fan clip adaptors into screw holes and install the fan clip into the adaptor

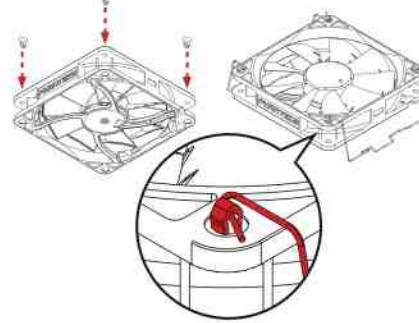

PH-TC12DX provides 8 pieces of fan clip adaptors, each fan requires 4 fan clip adaptors. Please put them into the 4 screw holes on each fan.

Caution: Please make sure the direction of the fan clip adaptors are correct. Refer to the image on the left.

Step 9: Put on rubber bar onto heatsink

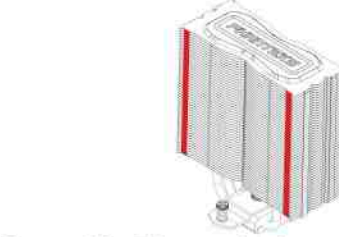

Please do not stick rubber bar onto other position, it may block the fan airflow into the heatsink to affect the convection efficiency.

Step 10: Place the heatsink on top of the CPU and secure the mounting plate

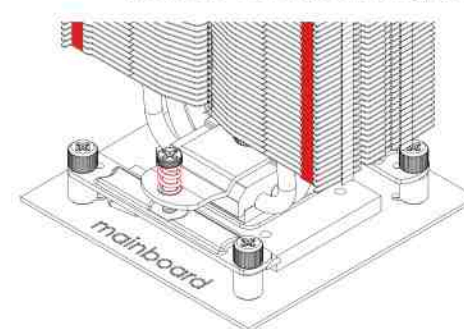

Please take off the protection cover at the bottom side of the heatsink first! Then put the heatsink on top of the CPU and screw it to the screw threads of the mounting plate.

Caution: Do not use force to overturn the screw, please stop when the screw is at a natural stop.

Step 11: Attach the side fan to the heatsink

Attach Phanteks PH-F120 fan with the metal wires fan clips.

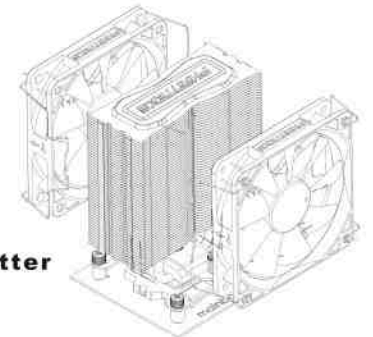

Step 12: Hook the fan cable with Fan splitter



Please connect the two fan's power cables to the FAN Splitter. Connect Fan Splitter to the motherboards CPU Fan header.

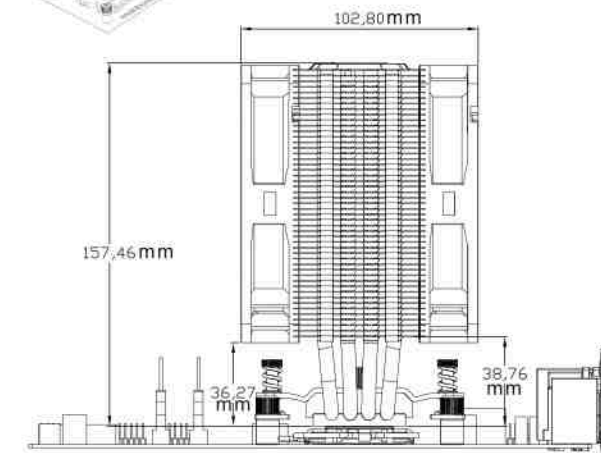

Final image

